

SERIE **118.09** ■ COUPLINGS FOR WATER CIRCUITS



Temperature Range - Temperaturbereich
-20°C +100°C (-4°F +212°F)

Working Pressure - Betriebsdruck
0-10 bar

Flow capacity - Nennweite
NW - 09

Material - Material

Coupler Body - Kupplungsgrundkörper: Brass Chrome plated - Messing Chrome beschichtet

Sleeve - Hülse: Brass Chrome plated - Messing Chrome beschichtet

Springs - Feder: Stainless Steel -Edelstahl

Seals - Dichtungen: NBR

Plug - Nippel: Brass Nickel plated - Messing Nickel beschichtet

Using Area:

- Cleaning, Washing
- Cleaning Machine
- Cooling water circuits
- Construction
- Food processing

**Coupler and Plug
Kupplung und Nippel**

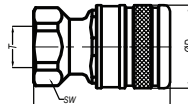

Female Threaded Coupler
Kupplung mit Innengewinde

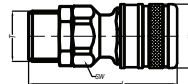

Male Threaded Coupler
Kupplung mit Aussengewinde



Hose Tail Coupler
Kupplung mit Schlauchtülle

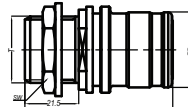

Panel Mounted Coupling
Kupplung mit Schottverschraubung

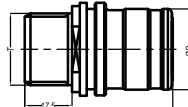

Male Threaded Coupler with Valve
Kupplung mit Aussengewinde mit Ventil

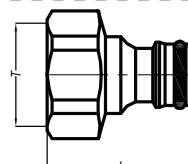

Female Threaded Plug
Nippel mit Innengewinde

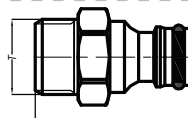

Male Threaded Plug
Nippel mit Aussengewinde

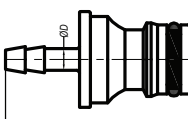

Hose Tail Plug
Nippel mit Schlauchtülle

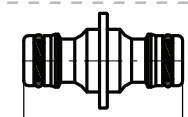

Adapter

Connection Anschlüsse T	Order No / Bestellnr.		ØD	L	SW
	Female Threaded Coupler Kupplung mit Innengewinde	Male Threaded Coupler Kupplung mit Aussengewinde			
BSP 1/2"	118.09 DG 21-01	118.09 DGF 21-01	35	57	30
BSP 3/4"	118.09 DG 26-01	118.09 DGF 26-01	35	57	30
BSP 1"	118.09 DG 33-01	118.09 DGF 33-01	35	60	38
BSP 1/2"	118.09 EG 21-01	118.09 EGF 21-01	30	77	35
BSP 3/4"	118.09 EG 26-01	118.09 EGF 26-01	30	81	35
Ø13mm-1/2"	118.09 HG 13-01	118.09 HGF 13-01	30	89	35
Ø16mm-5/8"	118.09 HG 16-01	118.09 HGF 16-01	30	89	35
Ø19mm-3/4"	118.09 HG 19-01	118.09 HGF 19-01	30	89	35
BSP 3/4"	118.09 SG 26-00		32	59	30
BSP 3/4"	118.09 EG 26-00		28	55	30
BSP 1/2"		118.09 DU 21		39	30
BSP 3/4"		118.09 DU 26		39	30
BSP 1"		118.09 DU 33		42	48
BSP 1/2"		118.09 EU 21		24	45
BSP 3/4"		118.09 EU 26		30	49
Ø6mm-1/4"		118.09 HU 06		43.5	
Ø8mm-5/8"		118.09 HU 08		43.5	
Ø10mm-3/8"		118.09 HU 10		43.5	
Ø13mm-1/2"		118.09 HU 03		43.5	
Ø16mm-5/8"		118.09 HU 16		43.5	
Ø19mm-3/4"		118.09 HU 19		43.5	
		118.09 HEF 00		50	