

HYDRAULIC COUPLINGS
HYDRAULIK KUPPLUNGEN

■ SERIE 085

SL : Safety lock - Sicherungsverriegelung



Couplers and Plugs
Kupplungen und Nippel

Body Size Nennweite	Connection Anschlüsse ØT	Order No Bestellnr.	ØD	L	SW
------------------------	--------------------------------	------------------------	----	---	----

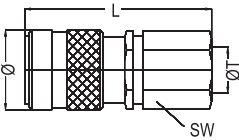

Female Threaded Shut-Off Coupler
Kupplung Innengewinde mit Ventil

03	BSPT 1/4"	085.03 QGB 13	27	62.9	
	BSPT 3/8"	085.03 QGB 17	27	62.9	
	BSP 1/8"	085.03 DGB 10	27	62.9	
	BSP 1/4"	085.03 DGB 13	27	62.9	
	BSP 1/4" (SL)	085.03 DGBS 13	27	61.5	
	BSP 3/8"	085.03 DGB 17	27	63.5	
	NPT 1/8"	085.03 NGB 13	27	54	
	NPT 1/4"	085.03 NGB 13	27	58.5	
	NPT 3/8"	085.03 NGB 13	27	60.5	
	NPT 1/4" (SL)	085.03 NGBS 13	27	58.5	

04	BSPT 1/4"	085.04 QGB 13	28	59.5	24
	BSPT 3/8"	085.04 QGB 13	28	61	24
	BSP 1/4"	085.04 DGB 13	28	61.5	24
	BSP 1/4" (SL)	085.04 DGBS 13	28	61.5	24
	BSP 3/8"	085.04 DGB 13	28	63.5	24
	NPT 1/4"	085.04 NGB 13	28	58.5	24
	NPT 3/8"	085.04 NGB 13	28	60.5	24
	NPT 1/4" (SL)	085.04 NGBS 13	28	58.5	24

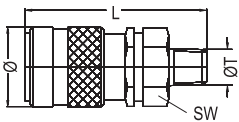

Male Threaded Shut-Off Coupler
Kupplung Aussengewinde mit Ventil

03	BSPT 1/4"	085.03 RGB 13	27	61.6	24
	BSPT 3/8"	085.03 RGB 17	27	61.6	24
	NPT 1/4"	085.03 TGB 13	27	61.6	24
	NPT 3/8"	085.03 TGB 17	27	61.6	24

04	BSPT 1/4"	085.04 RGB 13	27	61.6	24
	BSPT 3/8"	085.04 RGB 17	27	61.6	24
	NPT 1/4"	085.04 TGB 13	27	61.6	24
	NPT 3/8"	085.04 TGB 17	27	61.6	24

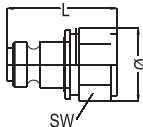

Female Threaded Shut-Off Plug
Verschlussnippel
Innengewinde mit Ventil

04	BSPT 1/4"	085.04 QUB 13	24.5	38	22
	BSPT 3/8"	085.04 QUB 17	27.7	39.5	24
	BSP 1/8"	085.04 DUB 10	24.5	35.5	22
	BSP 1/4"	085.04 DUB 13	24.5	38	22
	BSP 3/8"	085.04 DUB 17	27	39.5	24
	NPT 1/8"	085.04 NUB 10	24.5	33.5	22
	NPT 1/4"	085.04 NUB 13	24.5	38	22
	NPT 3/8"	085.04 NUB 17	27	39.5	24

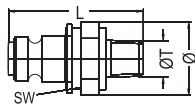

Male Threaded Shut-Off Plug
Verschlussnippel
Aussengewinde mit Ventil

04	BSPT 1/4"	085.04 RUB 13	24.5	62.5	22
	BSPT 3/8"	085.04 RUB 17	24.5	63	22
	BSP 1/4"	085.04 EUB 10	24.5	50	22
	NPT 1/4"	085.04 TUB 13	24.5	61.5	22
	NPT 3/8"	085.04 TUB 17	24.5	62	22



Dust caps for coupling
Schutzkappe für Kupplungen

085.03 KG 00R in plastic / aus Kunststoff
085.03 KG 01R in metal / aus Metall



Dust caps for plugs
Schutzkappe für Nippel

085.03 KU 00R in plastic / aus Kunststoff
085.03 KU 01R in metal / aus Metall

Interchangeability - Kompatibilität
CEJN 115 / CEJN 115FF

Temperature Range Temperaturbereich
-30°C +100°C (-22°F +212°F)

Working Pressure - Betriebsdruck

085.04 - 800 Bar - 80 MPa
085.03 - 1000 Bar - 100 MPa

Flow capacity - Nennweite

085.03 NW : 2.5 mm
085.04 NW : 4.0 mm

For 085.03 range black plastic dust caps
included as standard

Bei der Serie 085.03 sind rote
Schutzkappen enthalten

Attention :

The coupler and the plug
should not be loaded before connection.

Achtung :

Nicht unter Druck kuppeln
Der Nippel darf im ungekuppeltem
Zustand nicht unter Druck stehen.

Material - Material

C (Zinc Plated Steel - Stahl Verzinkt)

Coupler Body -
Kupplungsgrundkörper: Steel Zinc Plated-
Stahl Verzinkt

Back Part - : Steel Zinc Plated-

Hinterteil : Stahl Verzinkt

Sleeve - Hülse : Steel Zinc Plated-

Stahl Verzinkt

Valve - Ventil : Steel - Stahl

Springs - Federn : Steel - Stahl

Balls - Kugeln : Steel - Stahl

Seals - Dichtungen : Nitrile (Ni) - NBR

Springs and Balls : Steel - Stahl

Plug - Nippel : Steel Zinc Plated-

Stahl Verzinkt

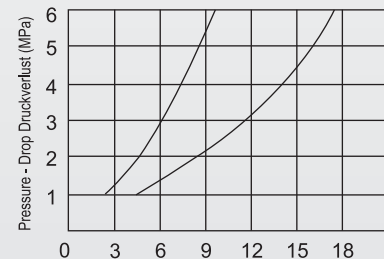

Flow - Durchfluss - L/min
(Oil-Oil t-50°C)
30c5