

COUPLINGS, MULTICOUPLINGS & MOULD COOLING PRODUCTS

KUPPLUNGEN, MULTIKUPPLUNGEN & KÜHLUNGSELEMENTE FÜR WERKZEUGE

SERIE 101



QUICK COUPLINGS FOR MOULD AND GENERAL INDUSTRY

SCHNELLVERSCHLUSSKUPPLUNGEN FÜR FORMWERKZEUGE UND ALLG. INDUSTRIE

For plastic injection moulding, heat transfer fluids and all industrial applications

Für Kühlung und Temperaturregelung von Kunststoffformen und Maschinen

Technical Specification:

Single or double shut-off
101.16 plug body manufactured from stainless steel and hardened
101.20 - 101.25 - 101.38 plug body manufactured from stainless steel
The O-ring for all 101 serie couplers are Fluorocarbon FPM (V).

Using Area :

- On cooling system of plastic zamak and aluminium injection molds
- On mould temperature control lines of thermoplastic injection moulding
- On water cooling circuit of welding machines
- On cleaning and washing systems of machines
- On hot oil lines connections
- All industries
- On steam lines

Nutzungsbereich:

- An Kühlsystemen für Kunststoff-, Zamak-, Messing und Aluminium-, Kokillenformen
- An Reinigungs- und Waschsyste-men von Maschinen
- An Heissölleitungsanschlüssen
- Alle Industriezweige
- An Dampfleitungen

Technische Eigenschaften:

- Ein-oder beidseitiges Ventil
- 101.16 Nippel aus gehärtetem Edelstahl
- 101.20 - 102.25 - 101.38 Kupplungskörper aus Edelstahl
- O-Ringe der Serie 101 sind FPM (V)

TST 101





SERIE 101 ■

COUPLINGS, MULTICOUPLINGS & MOULD COOLING PRODUCTS

KUPPLUNGEN, MULTIKUPPLUNGEN & KÜHLUNGSELEMENTE FÜR WERKZEUGE



QUICK COUPLINGS FOR MOULD AND GENERAL INDUSTRY

● **SCHNELLVERSCHLUSSKUPPLUNGEN FÜR FORMWERKZEUGE UND ALLG. INDUSTRIE** ●

● TST 101.06

Material - Material

- Coupler Body - Kupplungsgrundkörper : Brass - Messing
- Sleeve - Hülse : Stainless Steel - Edelstahl (AISI 420)
- Valve - Ventil : Brass - Messing
- Springs - Federn : Stainless Steel - Edelstahl
- Balls - Kugeln : Stainless Steel - Edelstahl
- Seals - Dichtungen : Fluorocarbon FPM (V)
- Plug - Nippel : Brass Nickel Plated - Messing Vernickelt



Ø Nominal - Nennweite (mm)	6	
Working Pressure - Betriebsdruck (bar)	16	
Cross section - Querschnitt (mm ²)	28,3	
Number of the Balls - Anzahl der Kugeln	6	
Working Temperature - Betriebstemperatur	V - Viton (FPM)	-10°C +200°C
	E - Ethylene Prop. (EPDM)	-20°C +150°C
	Ni - Nitrile (NBR)	-15°C +100°C
Flowing - Ausführung	Single Shut-Off	—○—+←
	Double Shut-Off	—○—+←○—
	Full Flow	—→+←

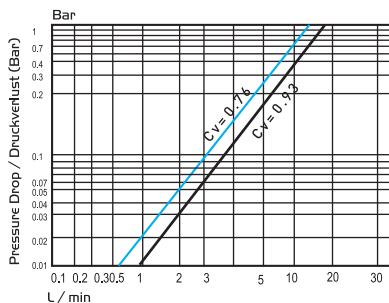

- Double Shut-off / Beidseitig absperrend
- Single Shut-off / Einseitig absperrend

Flow direction - Flußrichtung : Plug to socket - von Stecker zu Kupplung
Oil Viscosity at - Öl Viskosität 40° : C:13,4 cst

● TST 101.09

Material - Material

- Coupler Body - Kupplungsgrundkörper : Brass - Messing
- Sleeve - Hülse : Stainless Steel - Edelstahl (AISI 420)
- Valve - Ventil : Brass - Messing
- Springs - Federn : Stainless Steel - Edelstahl
- Balls - Kugeln : Stainless Steel - Edelstahl
- Seals - Dichtungen : Fluorocarbon FPM (V)
- Plug Body- Nippel : Brass Nickel Plated - Messing Vernickelt



Ø Nominal - Nennweite (mm)	9	
Working Pressure - Betriebsdruck (bar)	16	
Cross section - Querschnitt (mm ²)	63,9	
Number of the Balls - Anzahl der Kugeln	6	
Working Temperature - Betriebstemperatur	V - Viton (FPM)	-10°C +200°C
	E - Ethylene Prop. (EPDM)	-20°C +150°C
	Ni - Nitrile (NBR)	-15°C +100°C
Flowing - Ausführung	Single Shut-Off	—○—+←
	Double Shut-Off	—○—+←○—
	Full Flow	—→+←

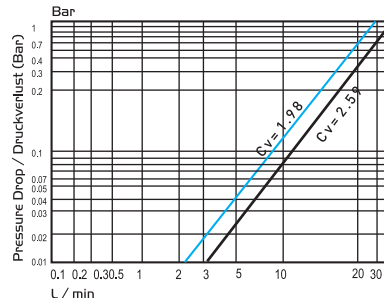

- Double Shut-off / Beidseitig absperrend
- Single Shut-off / Einseitig absperrend

Flow direction - Flußrichtung : Plug to socket - von Stecker zu Kupplung
Oil Viscosity at - Öl Viskosität 40° : C:13,4 cst

COUPLINGS, MULTICOUPLINGS & MOULD COOLING PRODUCTS

KUPPLUNGEN, MULTIKUPPLUNGEN & KÜHLUNGSELEMENTE FÜR WERKZEUGE

■ SERIE 101



QUICK COUPLINGS FOR MOULD AND GENERAL INDUSTRY

- SCHNELLVERSCHLUSSKUPPLUNGEN FÜR FORMWERKZEUGE UND ALLG. INDUSTRIE ●

● TST 101.12

Material - Material

- Coupler Body - Kupplungsgrundkörper : Brass - Messing
- Sleeve - Hülse : Stainless Steel - Edelstahl (AISI 420)
- Valve - Ventil : Brass - Messing
- Springs - Federn : Stainless Steel - Edelstahl
- Balls - Kugeln : Stainless Steel - Edelstahl
- Seals - Dichtungen : Fluorocarbon FPM (V)
- Plug - Nippel : Brass Nickel Plated - Messing Vernickelt



Ø Nominal - Nennweite (mm)	12	
Working Pressure - Betriebsdruck (bar)	16	
Cross section - Querschnitt (mm ²)	113	
Number of the Balls - Anzahl der Kugeln	6	
Working Temperature - Betriebstemperatur	V - Viton (FPM)	-10 °C +200 °C
	E - Ethylene Prop. (EPDM)	-20 °C +150 °C
	Ni - Nitrile (NBR)	-15 °C +100 °C
Flowing - Ausführung	Single Shut-Off	→←←
	Double Shut-Off	→←←→
	Full Flow	→←←→

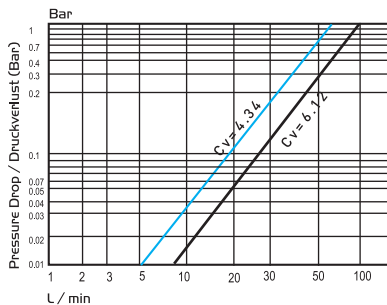

- Double Shut-off / Beidseitig absperrend
- Single Shut-off / Einseitig absperrend

Flow direction - Flußrichtung : Plug to socket - von Stecker zu Kupplung
Oil Viscosity at - Öl Viskosität 40° : C:13.4 cst

● TST 101.16

Material - Material

- Coupler Body - Kupplungsgrundkörper : Brass - Messing
- Sleeve - Hülse : Stainless Steel - Edelstahl (AISI 420)
- Valve - Ventil : Brass - Messing
- Springs - Federn : Stainless Steel - Edelstahl
- Balls - Kugeln : Stainless Steel - Edelstahl
- Seals - Dichtungen : Fluorocarbon FPM (V)
- Plug Body- Nippel : Stainless Steel - Edelstahl (AISI 420)



Ø Nominal - Nennweite (mm)	16	
Working Pressure - Betriebsdruck (bar)	16	
Cross section - Querschnitt (mm ²)	201	
Number of the Balls - Anzahl der Kugeln	12	
Working Temperature - Betriebstemperatur	V - Viton (FPM)	-10 °C +200 °C
	E - Ethylene Prop. (EPDM)	-20 °C +150 °C
	Ni - Nitrile (NBR)	-15 °C +100 °C
Flowing - Ausführung	Single Shut-Off	→←←
	Double Shut-Off	→←←→
	Full Flow	→←←→

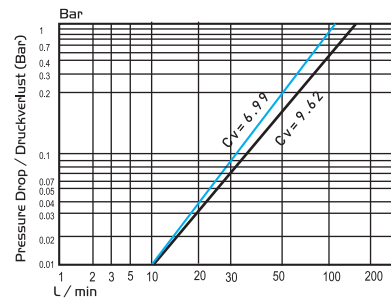

- Double Shut-off / Beidseitig absperrend
- Single Shut-off / Einseitig absperrend

Flow direction - Flußrichtung : Plug to socket - von Stecker zu Kupplung
Oil Viscosity at - Öl Viskosität 40° : C:13.4 cst

SERIE 101 ■

COUPLINGS, MULTICOUPLINGS & MOULD COOLING PRODUCTS

KUPPLUNGEN, MULTIKUPPLUNGEN & KÜHLUNGSELEMENTE FÜR WERKZEUGE



QUICK COUPLINGS FOR MOULD AND GENERAL INDUSTRY

● **SCHNELLVERSCHLUSSKUPPLUNGEN FÜR FORMWERKZEUGE UND ALLG. INDUSTRIE** ●

Leak-tight during connection Positive Überdeckung

● TST 101.20 TST 101.25

● TST 101.38

Material - Material

- Coupler Body -
- Kupplungsgrundkörper : Brass Nickel Plated - Messing Vernickelt
- Sleeve - Hülse : Stainless Steel - Edelstahl (AISI 420)
- Valve - Ventil : Brass Nickel Plated - Messing Vernickelt
- Springs - Federn : Stainless Steel - Edelstahl
- Balls - Kugeln : Stainless Steel - Edelstahl
- Seals - Dichtungen : Fluorocarbon FPM (V)
- Plug - Nippel : Stainless Steel - Edelstahl (AISI 420)



Ø Nominal - Nennweite (mm)		20	25
Working Pressure - Betriebsdruck (bar)		16	16
Cross section - Querschnitt (mm ²)		314	314
Number of the Balls - Anzahl der Kugeln		12	12
Working Temperature - Betriebstemperatur	V - Viton (FPM)	-10°C +200°C	-10°C +200°C
	E - Ethylene Prop. (EPDM)	-20°C +150°C	-20°C +150°C
	Ni - Nitrile (NBR)	-15°C +100°C	-15°C +100°C
Flowing - Ausführung	Single Shut-Off	→+←	→+←
	Double Shut-Off	→+←	→+←
	Full Flow	→+←	→+←

Interchangeability / Kompatibilität: TST Desing

Material - Material

- Coupler Body -
- Kupplungsgrundkörper : Brass Nickel Plated - Messing Vernickelt
- Sleeve - Hülse : Stainless Steel - Edelstahl (AISI 420)
- Valve - Ventil : Brass Nickel Plated - Messing Vernickelt
- Springs - Federn : Stainless Steel - Edelstahl
- Balls - Kugeln : Stainless Steel - Edelstahl
- Seals - Dichtungen : Fluorocarbon FPM (V)
- Plug Body- Nippel : Stainless Steel - Edelstahl (AISI 420)



Ø Nominal - Nennweite (mm)			38
Working Pressure - Betriebsdruck (bar)			16
Cross section - Querschnitt (mm ²)			1130
Number of the Balls - Anzahl der Kugeln			14
Working Temperature - Betriebstemperatur	V - Viton (FPM)	-10°C +200°C	-10°C +200°C
	E - Ethylene Prop. (EPDM)	-20°C +150°C	-20°C +150°C
	Ni - Nitrile (NBR)	-15°C +100°C	-15°C +100°C
Flowing - Ausführung	Single Shut-Off	→+←	→+←
	Double Shut-Off	→+←	→+←
	Full Flow	→+←	→+←

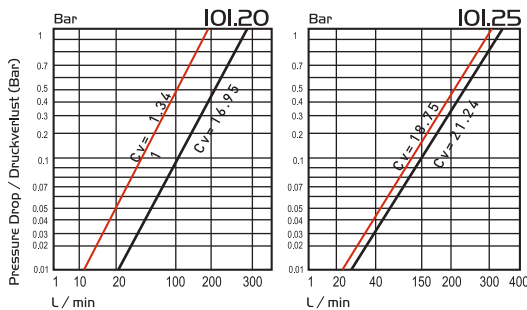

— Double Shut-off / Beidseitig absperrend
 — Single Shut-off / Einseitig absperrend

Flow direction - Flußrichtung : Plug to socket - von Stecker zu Kupplung
 Oil Viscosity at - Öl Viskosität 40° : C:13,4 cst

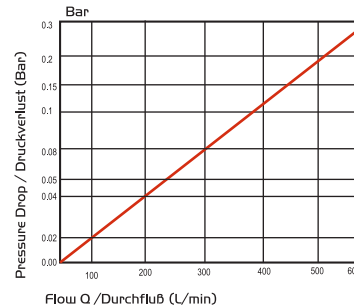

— Double Shut-off / Beidseitig absperrend

Flow direction - Flußrichtung : Plug to socket - von Stecker zu Kupplung
 Oil Viscosity at - Öl Viskosität 38° : 43 cst

COUPLINGS, MULTICOUPLINGS & MOULD COOLING PRODUCTS

KUPPLUNGEN, MULTIKUPPLUNGEN & KÜHLUNGSELEMENTE FÜR WERKZEUGE

SERIE 101



**Coupler
Kupplung**

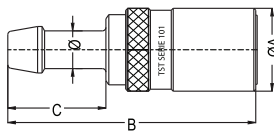

Coupler with hose tail
Kupplung mit Schlauchtülle

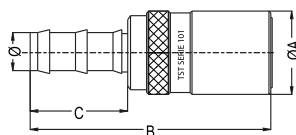

Push lock hose tail coupler
Kupplung mit Schnellsteck - Schlauchtülle

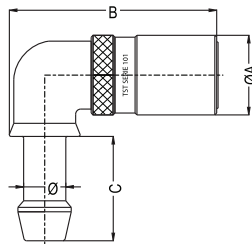

Coupler with hose tail 90°
Kupplung mit 90° Schlauchtülle

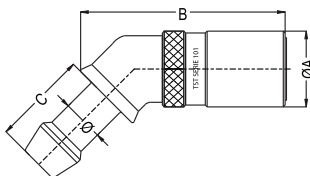

Coupler with hose tail 45°
Kupplung mit 45° Schlauchtülle

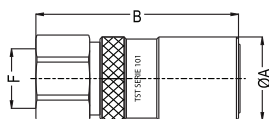

Coupler with female thread
Kupplung mit Innengewinde

NW Size/ Größe mm	Connection Anschlüsse (F/Ø)	Single & Double Shut-off Einseitig & Beidseitig absperrend	Full Flow Nicht absperrend	ØA	B	C	SW
		Order No / Bestellnr.	Order No / Bestellnr.				
6	08 - 5/16"	101.06 HGB 08		19.3	60	23	
9	12 - 15/32"	101.09 HGB 12		25	69	28.3	
12	13 - 1/2"	101.12 HGB 13		30.3	81.1	28	
12	16 - 5/8"	101.12 HGB 16		30.3	81.1	28	
16	16 - 5/8"	101.16 HGB 16		38	108	28	
16	19 - 3/4"	101.16 HGB 19		38	108	28	
16	19 - 3/4"			38	88	28	
6	10 - 3/8"	101.06 FGB 10	101.06 FGF 10	19.7	65.5	24	
9	10 - 3/8"	101.09 FGB 10	101.09 FGF 10	25	69.5	24	
9	13 - 1/2"	101.09 FGB 13	101.09 FGF 13	25	69.5	28	
12	13 - 1/2"	101.12 FGB 13	101.12 FGF 13	30.3	81.1	28	
16	16 - 5/8"	101.16 FGB 16	101.16 FGF 16	38	113	38	
16	19 - 3/4"	101.16 FGB 19	101.16 FGF 19	38	113	38	
6	08 - 5/16"	101.06 HGB 08-90°	101.06 HGF 08-90°	19.3	48.4	23	
9	10 - 3/8"	101.09 HGB 10-90°	101.09 HGF 10-90°	25	65	28	
9	12 - 15/32"	101.09 HGB 12-90°	101.09 HGF 12-90°	25	65	28	
12	16 - 5/8"	101.12 HGB 16-90°	101.12 HGF 16-90°	30.3	79.2	28	
16	19 - 3/4"	101.16 HGB 19-90°	101.16 HGF 19-90°	38	132	53	
6	08 - 5/16"	101.06 HGB 08-45°	101.06 HGF 08-135°	19.3	18.4	23	
6	BSP 1/4"	101.06 DGB 13	101.06 DGF 13	19.3	45.4	17	
6	NPT 1/4"	101.06 NGB 13	101.06 NGF 13	19.3	45.4	17	
9	BSP 3/8"	101.09 DGB 17	101.09 DGF 17	25	53.2	22	
9	NPT 1/4"	101.09 NGB 17	101.09 NGF 17	25	53.2	22	
12	BSP 1/2"	101.12 DGB 21	101.12 DGF 21	30.3	67	27	
12	NPT 1/2"	101.12 NGB 21	101.12 NGF 21	30.3	65	27	
16	BSP 3/4"	101.16 DGB 26	101.16 DGF 26	38	90	35	
16	BSP 3/4"		101.16 NGF 26SP	38	57	35	
16	NPT 3/4"	101.16 NGB 26	101.16 NGF 26	38	90	35	



COUPLINGS, MULTICOUPLINGS & MOULD COOLING PRODUCTS

SERIE 101

KUPPLUNGEN, MULTIKUPPLUNGEN & KÜHLUNGSELEMENTE FÜR WERKZEUGE



**Coupler
Kupplung**

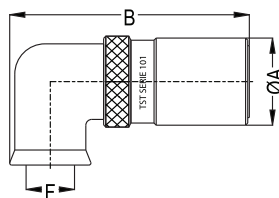

Coupler with female thread 90°
Kupplung mit 90° Innengewinde

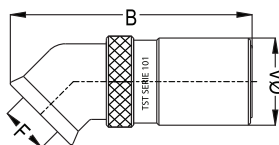

Coupler with female thread 45°
Kupplung mit 45° Innengewinde

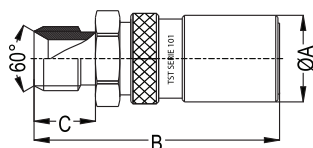

Coupler with male thread
Kupplung mit Aussengewinde

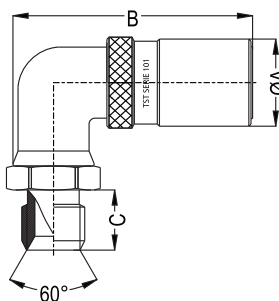

Coupler with male thread 90°
Kupplung mit 90° Aussengewinde

NW Size/ Größe mm	Connection Anschlüsse (F/Ø)	Single & Double Shut-off Einseitig & Beidseitig absperrend	Full Flow Nicht absperrend	ØA	B	C	SW
		Order No / Bestellnr.	Order No / Bestellnr.				
6	BSP 1/4"	101.06 DGB 13-90°	101.06 DGF 13-90°	19.3	57.5		
6	NPT 1/4"	101.06 NGB 13-90°	101.06 NGF 13-90°	19.3	57.5		
9	BSP 3/8"	101.09 DGB 17-90°	101.09 DGF 17-90°	25	65		
9	NPT 3/8"	101.09 NGB 17-90°	101.09 NGF 17-90°	25	65		
12	BSP 1/2"	101.12 DGB 21-90°	101.12 DGF 21-90°	37.3	81.1		
12	NPT 1/2"	101.12 NGB 21-90°	101.12 NGF 21-90°	37.3	81.1		
6	BSP 1/4"	101.06 DGB 13-45°	101.06 DGF 13-135°	19.3	48.4		
6	BSP 1/4"	101.06 EGB 13	101.06 EGF 13	19.3	51.5	17	
9	BSP 3/8"	101.09 EGB 17	101.09 EGF 17	25	61	22	
12	BSP 1/2"	101.12 EGB 21	101.12 EGF 21	30.3	72	27	
16	BSP 3/4"	101.16 EGB 26	101.16 EGF 26	38	95	32	
6	BSP 1/4"	101.06 EGB 13-90°	101.06 EGF 13-90°	19.3	57.5	17	
9	BSP 3/8"	101.09 EGB 17-90°	101.09 EGF 17-90°	25	65	22	
12	BSP 1/2"	101.12 EGB 21-90°	101.12 EGF 21-90°	30.3	81.1	27	
16	BSP 3/4"	101.16 EGB 26-90°	101.16 EGF 26-90°	38	132	32	

COUPLINGS, MULTICOUPLINGS & MOULD COOLING PRODUCTS

KUPPLUNGEN, MULTIKUPPLUNGEN & KÜHLUNGSELEMENTE FÜR WERKZEUGE

SERIE 101



Plug / Nippel

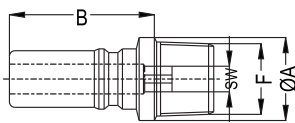

Tapered Male Threaded Plugs
Nippel mit konischem Aussengewinde

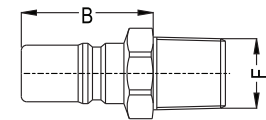

Tapered Male Threaded Plugs
Nippel mit konischem Aussengewinde

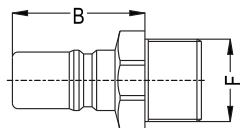

Male Threaded Plugs
Nippel mit zylindrischem Aussengewinde

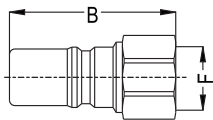

Female Threaded Plugs
Nippel mit Innengewinde

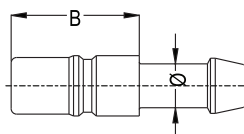

Hose tail plug
Nippel mit Schlauchtülle

NW Size/ Größe mm	Connection Anschlüsse (F/Ø)	Order No / Bestellnr.	B	ØD	SW
6	BSPT 1/8"	101.06 RU 10	21	10	5
6	BSPT 1/4"	101.06 RU 13	22	14	5
6	NPT 1/8"	101.06 TU 10	22	10	5
6	NPT 1/4"	101.06 TU 13	22	14	5
9	BSPT 1/4"	101.09 RU 13	21	14	8
9	BSPT 3/8"	101.09 RU 17	23	17	8
9	NPT 1/4"	101.09 TU 13	23	14	8
9	NPT 3/8"	101.09 TU 17	23	17	8
12	BSPT 3/8"	101.12 RU 17	26	18	10
12	BSPT 1/2"	101.12 RU 21	29		22
12	NPT 3/8"	101.12 TU 17	26		22
12	NPT 1/2"	101.12 TU 21	29		22
16	BSPT 1/2"	101.16 RU 21	39		24
16	BSPT 3/4"	101.16 RU 26	41.5		27
9	BSP 1/2"	101.09 EU 21	25		22
12	BSP 3/4"	101.12 EU 26	31		27
16	BSP 1"	101.16 EU 33	41.5		32
16	M24x1.5	101.16 EUM 24	39		30
6	BSP 1/4"	101.06 DU 13	34		17
6	NPT 1/4"	101.06 NU 13	36		17
9	BSP 3/8"	101.09 DU 17	37		22
9	NPT 3/8"	101.09 NU 17	37		22
12	BSP 1/2"	101.12 DU 21	45		27
12	NPT 1/2"	101.12 NU 21	46		27
16	BSP 3/4"	101.16 DU 26	58		32
16	NPT 3/4"	101.16 NU 26	60		32
6	Ø8 5/16"	101.06 HU 08	21		
9	Ø12 15/32"	101.09 HU 12	25		
12	Ø16 5/8"	101.12 HU 16	26		
16	Ø19 3/4"	101.16 HU 19	37		



SERIE 101

COUPLINGS, MULTICOUPLINGS & MOULD COOLING PRODUCTS

KUPPLUNGEN, MULTIKUPPLUNGEN & KÜHLUNGSELEMENTE FÜR WERKZEUGE



Shut-off Plugs
Verschlussnippel

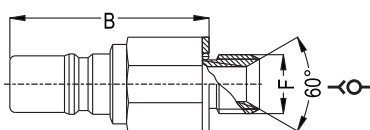

Male Threaded Shut-off Plugs with parallel tread
Verschlussnippel mit zylindrischem Aussengewinde

NW Size/ Größe mm	Connection Anschlüsse (F/Ø)	Order No / Bestellnr.	B	ØD	SW
6	BSP 1/8"	101.06 OUB 10	37		17
6	BSP 1/4"	101.06 OUB 13	34.5		17
9	BSP 1/4"	101.09 OUB 13	38		19
9	BSP 3/8"	101.09 OUB 17	38		20
12	BSP 3/8"	101.12 OUB 17	51.5		24
12	BSP 1/2"	101.12 OUB 21	50.4		27
16	BSP 3/4"	101.16 OUB 26	62.5		32

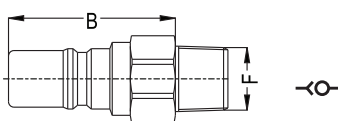

Tapered Male Shut-off Threaded Plugs
Verschlussnippel mit konischem Aussengewinde

6	BSPT 1/8"	101.06 RUB 10	36		17
6	BSPT 1/4"	101.06 RUB 13	33		17
6	NPT 1/8"	101.06 TUB 10	28		17
6	NPT 1/4"	101.06 TUB 13	33		17
9	BSPT 1/4"	101.09 RUB 13	36.5		19
9	BSPT 3/8"	101.09 RUB 17	38		19
9	NPT 1/4"	101.09 TUB 13	35		19
9	NPT 3/8"	101.09 TUB 17	35		19
12	BSPT 3/8"	101.12 RUB 17	50		24
12	BSPT 1/2"	101.12 RUB 21	47.5		24
12	NPT 3/8"	101.12 TUB 17	50		24
12	NPT 1/2"	101.12 TUB 21	47.5		24
16	BSPT 3/4"	101.16 RUB 26	62		32
16	NPT 3/4"	101.16 TUB 26	62		32

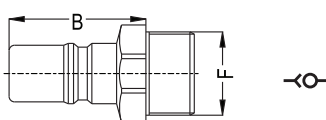

BSP Male Threaded Shut-off Plugs
Verschlussnippel mit zylindrischem Aussengewinde

6	BSP 3/8"	101.06 EUB 17	26		19
9	BSP 1/2"	101.09 EUB 21	25		22
12	BSP 3/4"	101.12 EUB 26	30		27
16	BSP 1"	101.16 EUB 33	38		32

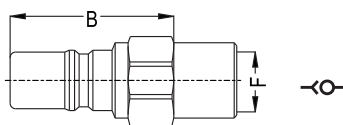

Female Threaded Shut-off Plugs
Verschlussnippel mit Innengewinde

6	BSP 1/4"	101.06 DUB 13	47		17
6	NPT 1/4"	101.06 NUB 13	47		17
9	BSP 1/4"	101.09 DUB 13	48.5		19
9	NPT 1/4"	101.09 NUB 13	48.5		19
9	BSP 3/8"	101.09 DUB 17	48.5		21
12	NPT 1/2"	101.12 NUB 21	63		27
16	BSP 3/4"	101.16 DUB 26	81		32
16	NPT 3/4"	101.16 NUB 26	81		32

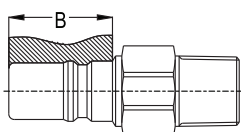

Connecting Size
Anschlussabmessungen

6		101.06	17.8		
9		101.09	19		
12		101.12	24		
16		101.16	31		

COUPLINGS, MULTICOUPLINGS & MOULD COOLING PRODUCTS

KUPPLUNGEN, MULTIKUPPLUNGEN & KÜHLUNGSELEMENTE FÜR WERKZEUGE

SERIE 101



Assembling of straight - through plugs on the mould Einbaumaße für Nippel (ohne Ventil) in Werkzeuge

Tapered Male Threaded Plugs
Nippel mit konischem Aussengewinde

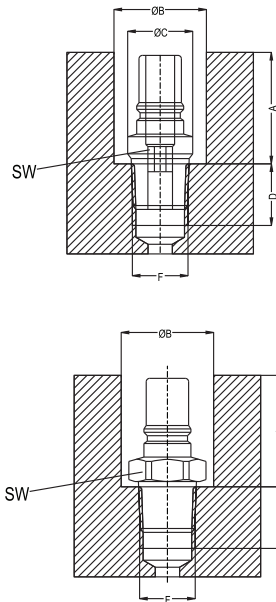

NW Size/ Größe mm	Connection Anschlüsse (F/Ø)	Order No / Bestellnr.	ØA	ØB	ØC	D	SW
6	BSPT 1/8"	101.06 RU 10	26	20	10	9	5
6	NPT 1/8"	101.06 TU 10	28	20	11	9	5
6	BSPT 1/4"	101.06 RU 13	27	20	14	11	5
6	NPT 1/4"	101.06 TU 13	27	20	14	12	5
9	BSPT 1/4"	101.09 RU 13	26	26	14	12	8
9	NPT 1/4"	101.09 TU 13	28	26	14	13	8
9	BSPT 3/8"	101.09 RU 17	28	26	17	13	8
9	NPT 3/8"	101.09 TU 17	28	26	17	13	8
12	BSPT 3/8"	101.12 RU 17	31	33	18	13	10
12	NPT 3/8"	101.12 TU 17	31	33		13	10
12	BSPT 1/2"	101.12 RU 21	34	33		16	22
12	NPT 1/2"	101.12 TU 21	34	33		17	22
16	BSPT 3/4"	101.16 RU 26	46	40		18	27

Assembling of self-sealing plugs on the mould Einbaumaße für Verschlussnippel in Werkzeuge

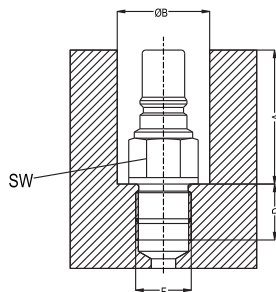

Shut-off Plug with cylindrical male thread
Verschlussnippel mit zylindrischem Aussengewinde

6	BSP 1/8"	101.06 EUB 10	36	40		8	17
6	BSP 1/4"	101.06 EUB 13	33	27		9	17
9	BSP 1/4"	101.09 EUB 13	36	29		9	19
9	BSP 3/8"	101.09 EUB 17	36	30		12	19
12	BSP 3/8"	101.12 EUB 17	50	36		9	24
12	BSP 1/2"	101.12 EUB 21	50	36		12	24
16	BSP 3/4"	101.16 EUB 26	64	46		16	32

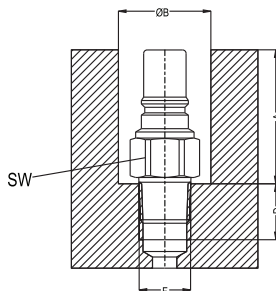

Shut-off Plug with conical male thread
Verschlussnippel mit konischem Aussengewinde

6	BSPT 1/8"	101.06 RUB 10	36	27		10	17
6	NPT 1/8"	101.06 TUB 10	36	27		9	17
6	BSPT 1/4"	101.06 RUB 13	33	27		12	17
6	NPT 1/4"	101.06 TUB 13	33	27		13	17
9	BSPT 1/4"	101.09 RUB 13	36,5	29		12	19
9	NPT 1/4"	101.09 TUB 13	35	29		11	19
9	BSPT 3/8"	101.09 RUB 17	35	29		12	19
9	NPT 3/8"	101.09 TUB 17	35	29		12	19
12	BSPT 3/8"	101.12 RUB 17	50	36		13	24
12	NPT 3/8"	101.12 TUB 17	50	36		13	24
12	BSPT 1/2"	101.12 RUB 21	48	36		17	24
12	NPT 1/2"	101.12 TUB 21	48	36		17	24
16	BSPT 3/4"	101.16 RUB 26	62	46		21	32
16	NPT 3/4"	101.16 TUB 26	62	46		21	32



SERIE 101 ■

COUPLINGS, MULTICOUPLINGS & MOULD COOLING PRODUCTS

KUPPLUNGEN, MULTIKUPPLUNGEN & KUHLUNGSELEMENTE FÜR WERKZEUGE



Standard version - Standardversion
Viton O-Ring (FPM)
Double Shut-off - beideseitig absperrend

Options - Optionen
E - EPDM Seal - EPDM Dichtung
F - Through Flow - freier Durchfluß

For optional orders please add the symbol of your option end of the order no.
Bei Bestellungen Kennbuchstabe bitte hinzufügen
(Beispiel: 101.20 EG 33 E-F)

Material - Material

- Coupler Body - Kupplungsgrundkörper
Sleeve - Hülse
Valve - Ventil
Springs - Federn
Balls - Kugeln
Seals - Dichtungen
Plug - Nippel
- : Brass - Messing
 - : Stainless Steel - Edelstahl
 - : Brass - Messing
 - : Stainless Steel - Edelstahl
 - : Stainless Steel - Edelstahl
 - : Viton (V)
 - : Stainless Steel - Edelstahl

**Coupler and Plug
Kupplung und Nippel**

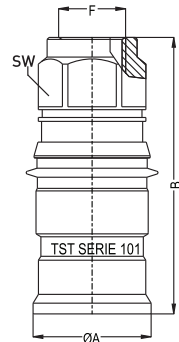

Shut-off Coupler With Female Thread
Kupplung mit Innengewinde und Ventil

Size Nennweite mm	Connection Anschlüsse (F/Ø)	Order No Bestellnr.	ØA	B	C	SW
20	BSP 3/4"	101.20 DGB 26	53	117		41
20	NPT 3/4"	101.20 NGB 26	53	117		41
20	BSP 1"	101.20 DGB 33	53	117		41
20	NPT 1"	101.20 NGB 33	53	117		41
25	BSP 1"	101.25 DGB 33	60	140.8		50
25	BSP 1"1/4	101.25 DGB 42	60	140.8		50
38	BSP 1"1/2	101.38 DGB 48	82.3	158.4		70
38	BSP 2"	101.38 DGB 60	82.3	168.4		75

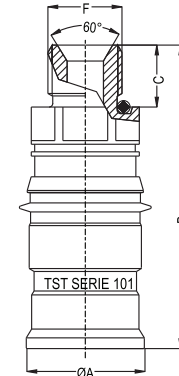

Shut-off Coupler With Male Parallel Thread
Kupplung mit zylindrischem Aussengewinde und Ventil

20	BSP 1"	101.20 EGB 33	53	131.5	19	41
25	BSP 1"	101.25 EGB 33	60	142	19	50
25	BSP 1"1/4	101.25 EGB 42	60	144	22	50
38	BSP 1"1/2	101.38 EGB 48	82.3	182	22	70

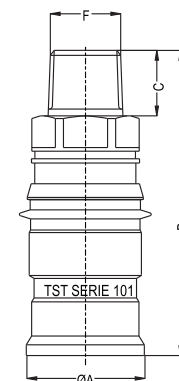

NPT Male Threaded Shut-off Coupler
Kupplung mit NPT Aussengewinde und Ventil

20	NPT 1"	101.20 TGB 33	53	133.5	21	41
25	NPT 1"	101.25 TGB 33	60	144	21	50
25	NPT 1"1/4	101.25 TGB 42	60	147	15	50
38	NPT 1"1/2	101.38 TGB 48	82.3	184	27	70
38	NPT 2"	101.38 TGB 60	82.3	187	27	70

COUPLINGS, MULTICOUPLINGS & MOULD COOLING PRODUCTS

KUPPLUNGEN, MULTIKUPPLUNGEN & KÜHLUNGSELEMENTE FÜR WERKZEUGE

SERIE 101



**Coupler and Plug
Kupplung und Nippel**

Size Nennweite mm	Connection Anschlüsse (F/Ø)	Order No Bestellnr.	ØA	B	C	SW
-------------------------	-----------------------------------	------------------------	----	---	---	----

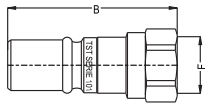

Plug With Female Thread
Nippel mit Innengewinde

20	BSP 1"	101.20 DU 33		92		41
25	BSP 1"	101.25 DU 33		100		41
38	BSP 1"1/2	101.38 DU 48		156		70

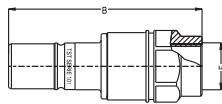

Shut-off Plug With
Female Thread
Verschlussnippel mit
Innengewinde

20	BSP 3/4"	101.20 DUB 26		126.5		41
20	BSP 1"	101.20 DUB 33		126.5		41
20	NPT 1"	101.20 NUB 33		126.5		41
25	BSP 1"	101.25 DUB 33		148.5		50
25	BSP 1"1/4	101.25 DUB 42		148.5		50
38	BSP 1"1/2	101.38 DUB 48		156		70
38	BSP 2"	101.38 DUB 60		165		75

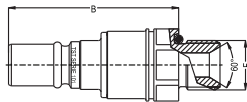

Shut-off Plug With
Male Parallel Thread
Verschlussnippel mit
zylindrischem
Aussengewinde

20	BSP 1"	101.20 EUB 33		122		41
25	BSP 1"	101.25 EUB 33		131.5		50
25	BSP 1"1/4	101.25 EUB 42		131.5		50
38	BSP 1"1/2	101.38 EUB 48		156		70
38	BSP 2"	101.38 EUB 60		156		70

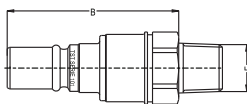

NPT Male Threaded
Shut-off Plug
Verschlussnippel mit
NPT Aussengewinde

20	NPT 1"	101.20 TUB 33		122		41
25	NPT 1"	101.25 TUB 33		131.5		50
25	NPT 1"1/4	101.25 TUB 42		131.5		50
38	NPT 1"1/2	101.38 TUB 48		156		70
38	NPT 2"	101.38 TUB 60		156		70

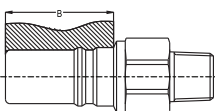

Connecting Size
Anschlussabmessungen

20		101.20		61		
25		101.25		72		
38		101.38		74.4		

Standard version - Standardversion
Viton O-Ring (FPM)
Double Shut-off - beideseitig absperrend

Options - Optionen
E - EPDM Seal - EPDM Dichtung
F - Through Flow - freier Durchfluß

For optional orders please add the symbol of your option end of the order no.
Bei Bestellungen Kennbuchstabe bitte hinzufügen
(Beispiel: 101.20 EG 33 E-F)

Material - Material

Coupler Body -
Kupplungsgrundkörper
: Brass - Messing
Sleeve - Hülse : Stainless Steel - Edelstahl
Valve - Ventil : Brass - Messing
Springs - Federn : Stainless Steel - Edelstahl
Balls - Kugeln : Stainless Steel - Edelstahl
Seals - Dichtungen : Viton (V)
Plug - Nippel : Stainless Steel - Edelstahl

SERIE 101 ■

COUPLINGS, MULTICOUPLINGS & MOULD COOLING PRODUCTS

KUPPLUNGEN, MULTIKUPPLUNGEN & KÜHLUNGSELEMENTE FÜR WERKZEUGE

MULTI COUPLINGS MULTIKUPPLUNGSSYSTEME

TST Multi coupling systems are applicable for quick changing of injection moulding and die cast equipments. This system avoids from the wrong connections in a quick and simple way.

tst Multi Coupling connection is starting from 3 circuits and it may increase up to 12 circuits + according to customer needs. Water Couplers for max 10 bar and 180 °C and also there exist manual multi couplers for electrical and hydraulic connections in our product range.

TST Standard Multi Coupling Ranges

- M106 (Flow Size : 6 mm)
- M109 (Flow Size : 9 mm)
- M112 (Flow Size : 12 mm)
- M116 (Flow Size : 16 mm)

According to the requested coupler quantity:

- 6 couplers : 3 circuits
- 8 couplers : 4 circuits
- 10 couplers : 5 circuits
- 12 couplers : 6 circuits
- 16 couplers : 8 circuits
- 20 couplers : 10 circuits
- 24 couplers : 12 circuits

tst Multikupplungssysteme werden zur Verkürzung der Werkzeugwechselzeit im Spritzguss und Druckguss eingesetzt. Diese Systeme verhindern zusätzlich ein Verwechseln der einzelnen Kreisläufe untereinander.

tst Multikupplungssysteme gibt es ab 3 bis über 12 Kreisläufe je nach Kundenanforderung.

Wasserkupplungen sind ausgelegt für maximal 10bar und 180C° und es gibt ebenso manuell zu betätigende Multikupplungen für Elektrik und Hydraulik in unserem Produktportfolio.

tst Standard Multikupplungsserien

- M106 (NW : 6 mm)
- M109 (NW : 9 mm)
- M112 (NW : 12 mm)
- M116 (NW : 16 mm)

Entsprechend der angeforderten Kupplungsmenge :

- 6 Kupplungen : 3 Kreisläufe
- 8 Kupplungen : 4 Kreisläufe
- 10 Kupplungen : 5 Kreisläufe
- 12 Kupplungen : 6 Kreisläufe
- 16 Kupplungen : 8 Kreisläufe
- 20 Kupplungen : 10 Kreisläufe
- 24 Kupplungen : 12 Kreisläufe

