

**PNEUMATIC COUPLINGS**  
PNEUMATISCHE KUPPLUNGEN

**SERIE 027**

SUPER FLOW **SUPERDURCHFLOSS**



**Couplers and Plugs**  
Kupplungen und Nippel

Connection  
Anschlüsse

Order No  
Bestellnr.

SW

L

ØD

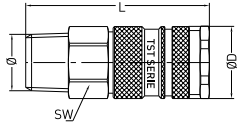

Male Thread Coupling  
Kupplungen mit Aussengewinde

|           |           |    |      |    |
|-----------|-----------|----|------|----|
| BSPT 1/4" | 027 RG 13 | 24 | 64,8 | 27 |
| BSPT 3/8" | 027 RG 17 | 24 | 64,8 | 27 |
| BSPT 1/2" | 027 RG 21 | 24 | 64,8 | 27 |
| BSPT 3/4" | 027 RG 26 | 27 | 64,8 | 27 |
| BSP 1/4"  | 027 EG 13 | 24 | 65,8 | 27 |
| BSP 3/8"  | 027 EG 17 | 24 | 65,8 | 27 |
| BSP 1/2"  | 027 EG 21 | 24 | 66,8 | 27 |
| BSP 3/4"  | 027 EG 26 | 30 | 68,8 | 27 |

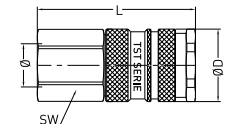

Female Thread Coupling  
Kupplung mit Innengewinde

|          |           |    |      |    |
|----------|-----------|----|------|----|
| BSP 1/4" | 027 DG 13 | 24 | 58,8 | 27 |
| BSP 3/8" | 027 DG 17 | 24 | 58,8 | 27 |
| BSP 1/2" | 027 DG 21 | 24 | 61,8 | 27 |
| NPT 1/4" | 027 TG 13 | 24 | 61,8 | 27 |
| NPT 3/8" | 027 TG 17 | 24 | 62,8 | 27 |
| NPT 1/2" | 027 TG 21 | 24 | 66,8 | 27 |

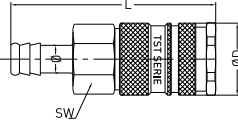

Standard Hose Barb Coupling  
Kupplung mit Schlauchtülle

|              |           |    |      |    |
|--------------|-----------|----|------|----|
| 6 mm - 1/4"  | 027 HG 06 | 24 | 74,8 | 27 |
| 8 mm - 5/16" | 027 HG 08 | 24 | 74,8 | 27 |
| 9 mm - 5/14" | 027 HG 09 | 24 | 74,8 | 27 |
| 10 mm - 3/8" | 027 HG 10 | 24 | 74,8 | 27 |
| 13 mm - 1/2" | 027 HG 13 | 24 | 74,8 | 27 |

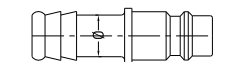

Standard Hose Barb Plug  
Nippel mit Schlauchtülle

|              |           |  |    |    |
|--------------|-----------|--|----|----|
| 6 mm - 1/4"  | 027 HU 06 |  | 48 | 16 |
| 8 mm - 5/16" | 027 HU 08 |  | 48 | 16 |
| 9 mm - 5/14" | 027 HU 09 |  | 48 | 16 |
| 10 mm - 3/8" | 027 HU 10 |  | 48 | 16 |
| 13 mm - 1/2" | 027 HU 13 |  | 48 | 16 |

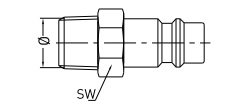

Male Thread Plug  
Nippel mit Aussengewinde

|           |           |    |      |    |
|-----------|-----------|----|------|----|
| BSPT 1/8" | 027 RU 10 | 17 | 41,5 | 27 |
| BSPT 1/4" | 027 RU 13 | 17 | 41,5 | 27 |
| BSPT 3/8" | 027 RU 17 | 17 | 42,5 | 27 |
| BSPT 1/2" | 027 RU 21 | 22 | 48   | 27 |
| BSP 1/8"  | 027 EU 10 | 17 | 38,5 | 27 |
| BSP 1/4"  | 027 EU 13 | 17 | 38,5 | 27 |
| BSP 3/8"  | 027 EU 17 | 17 | 38,5 | 27 |
| BSP 1/2"  | 027 EU 21 | 22 | 43   | 27 |

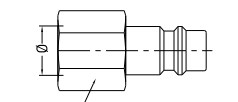

Female Thread Plug  
Nippel mit Innengewinde

|          |           |    |    |  |
|----------|-----------|----|----|--|
| BSP 1/4" | 027 DU 13 | 17 | 40 |  |
| BSP 3/8" | 027 DU 17 | 19 | 40 |  |
| BSP 1/2" | 027 DU 21 | 24 | 46 |  |

**Interchangeability - Kompatibilität**  
RECTUS 27, CEJN 410, TST 410

**Temperature Range - Temperaturbereich**  
-20°C +100°C (-4°F +212°F)

**Working Pressure - Betriebsdruck**  
0 - 35 bar (0 - 508 PSI)

**Flow capacity - Nennweite**  
NW - 10

**Option - Optionen**

F - Straight through flow -  
ungehinderter Durchfluss  
S - Stainless Steel - Edelstahl  
V - Viton Seal - Viton Dichtung

For optional orders please add the symbol of  
your option end of the order no.

Bei Optionsbestellungen Kennbuchstabe  
bitte hinzufügen (Beispiel: 027 RG 13-K-V)

**Material - Material**

**Coupler Body -**

Kupplungsgrundkörper: Brass Nickel Plated -  
Messing vernickelt

**Back Part -**

Hinterteil : Brass Nickel Plated -  
Messing vernickelt

**Sleeve - Hülse**

: Steel Nickel Plated -  
Stahl vernickelt

**Valve - Ventil**

: Brass - Messing

**Springs - Federn**

: Stainless Steel - Edelstahl

**Balls - Kugeln**

: Stainless Steel -  
Edelstahl AISI 420

**Seals - Dichtungen**

: Nitrile (Ni) - NBR (Ni)

**Plug - Nippel**

: Steel Nickel Plated -  
Stahl vernickelt

