

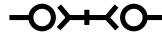

SERIE **036-10B**

PNEUMATIC COUPLINGS
PNEUMATISCHE KUPPLUNGEN



BRASS / MESSING

Interchangeability - Kompatibilität
CEJN 414
CEJN 416 - TST 036.10-S6

Temperature Range - Temperaturbereich
-20°C +100°C (-4°F +212°F)

Working Pressure - Betriebsdruck
036 - Brass - Messing: 35 Bar - (508 PSI)
036S - St. Steel - Edelstahl: 70 Bar - (1015 PSI)

Flow capacity - Nennweite
NW - 9,5

Material - Material - B
(Nickel Plated Brass - Messing Vernickelt)

Coupler Body - Kupplungsgrundkörper : Brass Nickel Plated - Messing vernickelt

Sleeve - Hülse : Brass Nickel Plated - Messing vernickelt

Valve - Ventil : Brass - Messing
Springs - Federn : Stainless Steel - Edelstahl
Balls - Kugeln : Stainless Steel - Edelstahl
Seals - Dichtungen : Fluorocarbon FPM (V)

Plug - Nippel : Brass Nickel Plated - Messing vernickelt

Material - Material - S6
(Stainless Steel - Edelstahl (AISI- 316))

Coupler Body - Kupplungsgrundkörper : Stainless Steel - Edelstahl (AISI- 316)

Sleeve - Hülse : Stainless Steel - Edelstahl (AISI- 316)

Valve - Ventil : Stainless Steel - Edelstahl (AISI- 316)

Springs - Federn : Stainless Steel - Edelstahl

Balls - Kugeln : Stainless Steel - Edelstahl

Seals - Dichtungen : Fluorocarbon FPM (V)

Plug - Nippel : Stainless Steel - Edelstahl (AISI- 316)

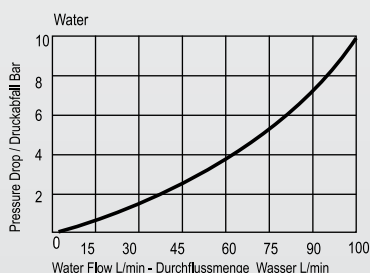
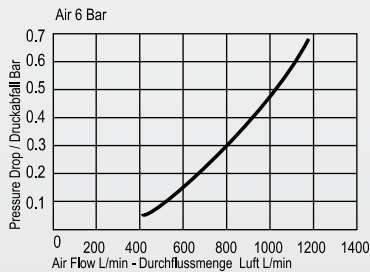

Couplers and Plugs
Kupplungen und Nippel

Connection
Anschlüsse
Ø

Order No.
Bestellnr.

SW

L

ØD

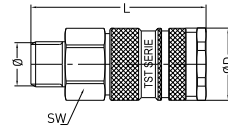

Male Threaded Coupling
Kupplung mit Aussengewinde

BSP 1/4"	036.10 RGB 13	25	65,7	28
BSP 3/8"	036.10 RGB 17	25	65,7	28
BSP 1/2"	036.10 RGB 21	25	69,7	28

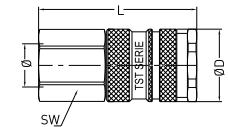

Female Thread Coupling
Kupplung mit Innengewinde

BSP 1/4"	036.10 DGB 13	25	59,7	28
BSP 3/8"	036.10 DGB 17	25	59,7	28
BSP 1/2"	036.10 DGB 21	25	62,7	28

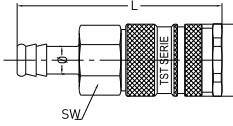

Standard Hose Barb Coupling
Kupplung mit Schlauchtülle

9 mm - 5/16"	036.10 HGB 09	25	74,7	28
10 mm - 3/8"	036.10 HGB 10	25	74,7	28
13 mm - 1/2"	036.10 HGB 13	25	74,7	28

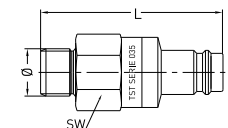

Male Thread Plug
Nippel mit Aussengewinde

BSPT 1/4"	036.10 RUB 13	25	63,7	28
BSPT 3/8"	036.10 RUB 17	25	63,7	28
BSPT 1/2"	036.10 RUB 21	25	67,7	28

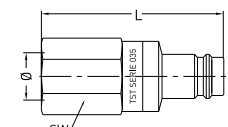

Female Thread Plug
Nippel mit Innengewinde

BSP 1/4"	036.10 DUB 13	25	57,7	28
BSP 3/8"	036.10 DUB 17	25	57,7	28
BSP 1/2"	036.10 DUB 21	25	60,7	28

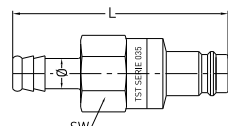

Standard Hose Barb Plug
Nippel mit Schlauchtülle

9 mm - 5/16"	036.10 HUB 09	25	72,7	28
10 mm - 3/8"	036.10 HUB 10	25	72,7	28
13 mm - 1/2"	036.10 HUB 13	25	72,7	28